

## BASISREGELS VOOR DESIGN VAN TE METALLISEREN COMPONENTEN

### LASNADEN - RANDEN

- Lassen in één doorlopende lasnaad
- Bij voorkeur lassen alvorens te metalliseren, indien nadien-> maskeren tot 100 mm
- Randen afronden
- Lasergesneden randen: ruwheid – afronden – bramen

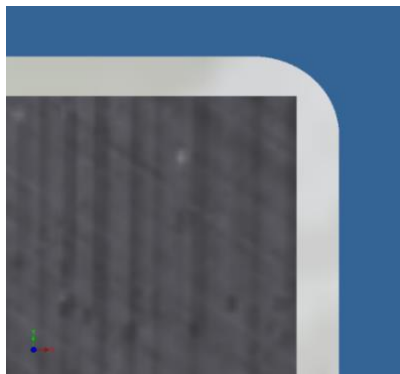

slecht

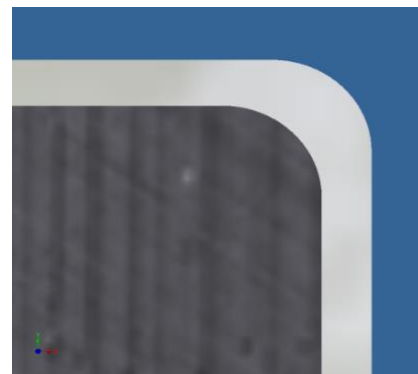

goed

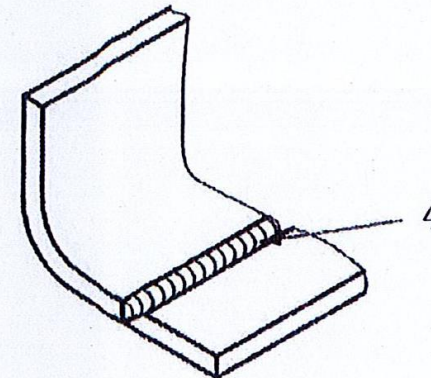
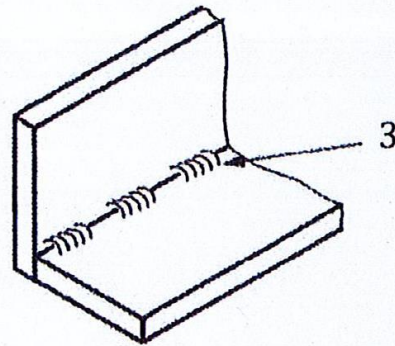
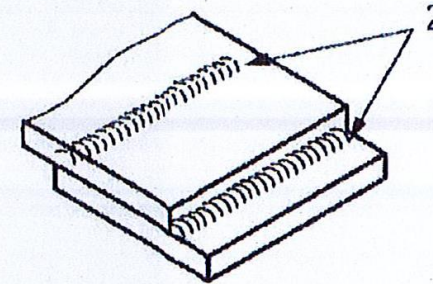
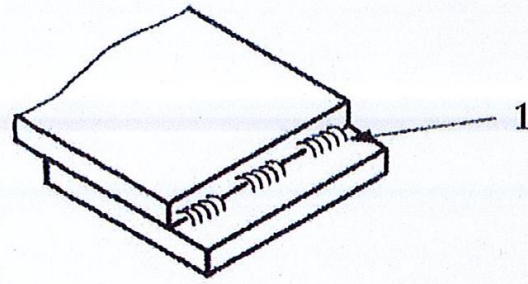

- 1 Overlapping joints with discontinuous welds are to be avoided.
- 2 Overlapping fully sealed by continuous welds, smooth and free from slag and weld spatter are to be preferred.
- 3 Sharp corners and discontinuous welds are to be avoided.
- 4 Rounded corners and continuous butt welds are to be preferred.