

Règles de base pour le design des composants à métalliser

Soudures – bords:

- Des soudures continu
- De préférence faire les soudures avant métallisation, si après-> masquage à 100 mm
- Arrondir les bords
- Bords coupés au laser: rugosité – arrondir – bavures

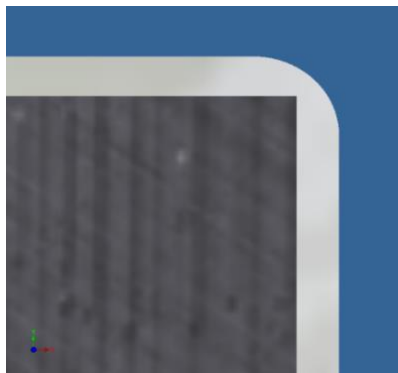

mauvais

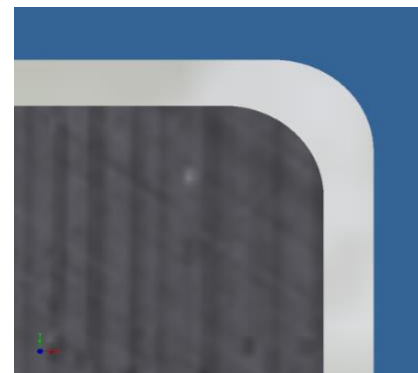

bon

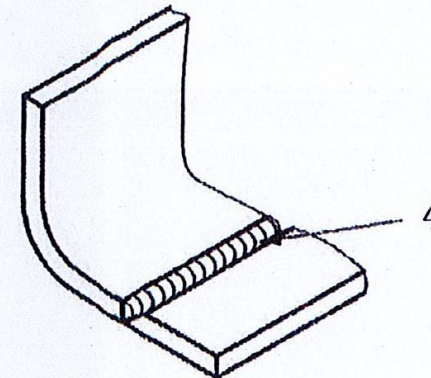
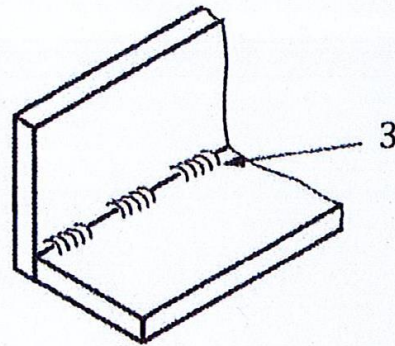
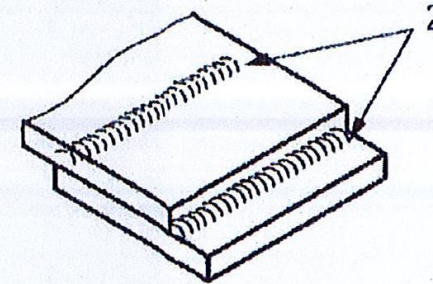
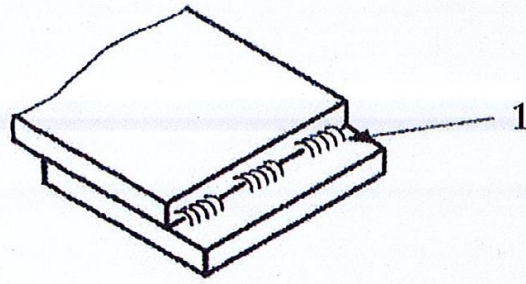

- 1 Overlapping joints with discontinuous welds are to be avoided.
- 2 Overlapping fully sealed by continuous welds, smooth and free from slag and weld spatter are to be preferred.
- 3 Sharp corners and discontinuous welds are to be avoided.
- 4 Rounded corners and continuous butt welds are to be preferred.